

### **QuickLine® Studio Furniture**

**By PR&E**

#### **High Quality, Cost Effective Studio Furniture**

Building a great looking, functional studio is a challenge, remaining within a budget is a must. Harris' QuickLine modular studio furniture by Pacific Research & Engineering boasts a variety of options to meet both of those requirements.

#### **Features/Benefits**

- ▶ Flexible modular design
- ▶ Pre-engineered modules to customize studio configurations
- ▶ Several different guest wing options, both on the side and across from the operator
- ▶ Attractive and durable T-mold trim and HPL tops
- ▶ Under counter rack space
- ▶ Rear access doors for below counter racks and table top rack turrets
- ▶ Quick disconnect hinges on doors allow for complete removal
- ▶ Easy installation
- ▶ All necessary hardware and assembly instructions included
- ▶ Compliments the popular Harris SmoothLine Custom Cabinetry



**QuickLine Studio Furniture Specifications**

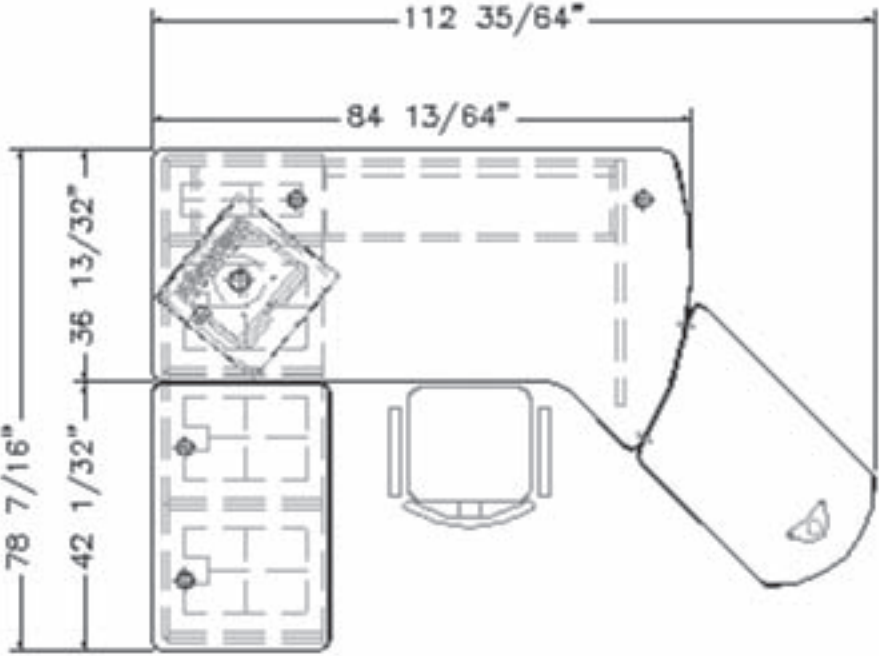
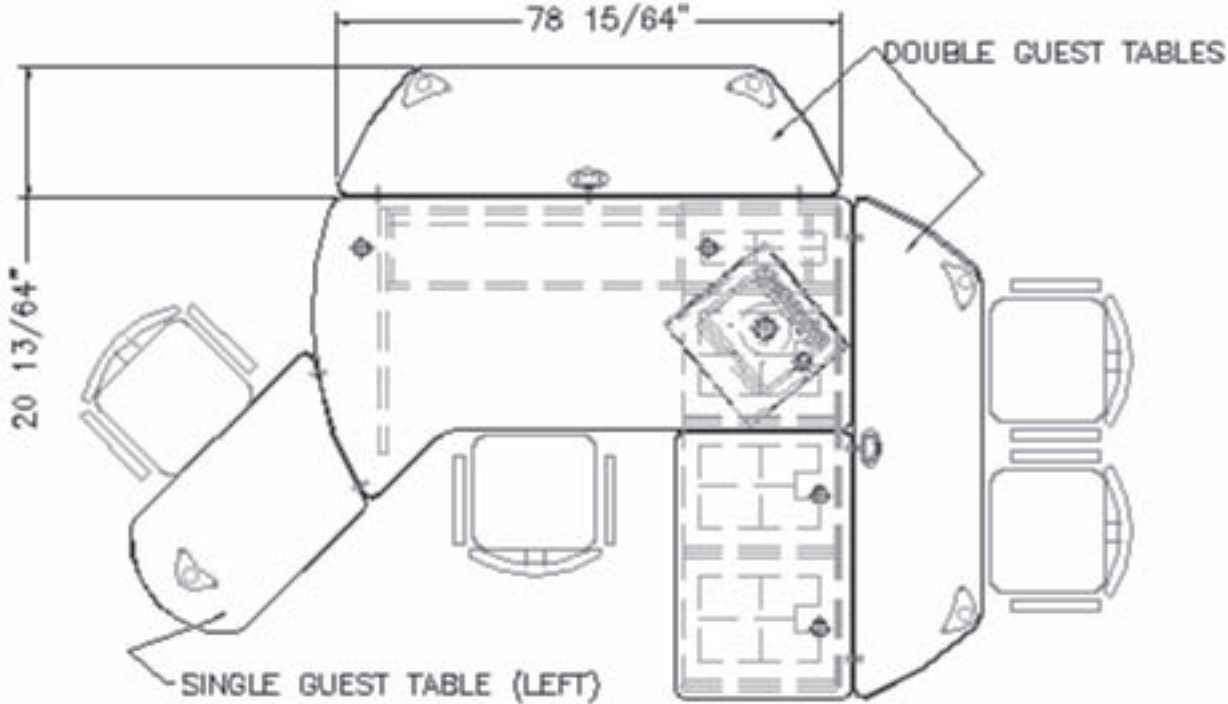

Specifications subject to change without notice.



Broadcast Communications Division | 4393 Digital Way | Mason, OH USA 45040  
 phone: 513-459-3400 | email: broadcast@harris.com | www.harris.com

assuredcommunications™

Copyright © 2006 Harris Corporation  
 BAC ADV. 1064A 03/06